

Tool Box – Actuation Test

This is a function of performing forced self-driving and stopping various actuators installed on vehicles through a control module, which can inspect the normal driving status of parts.

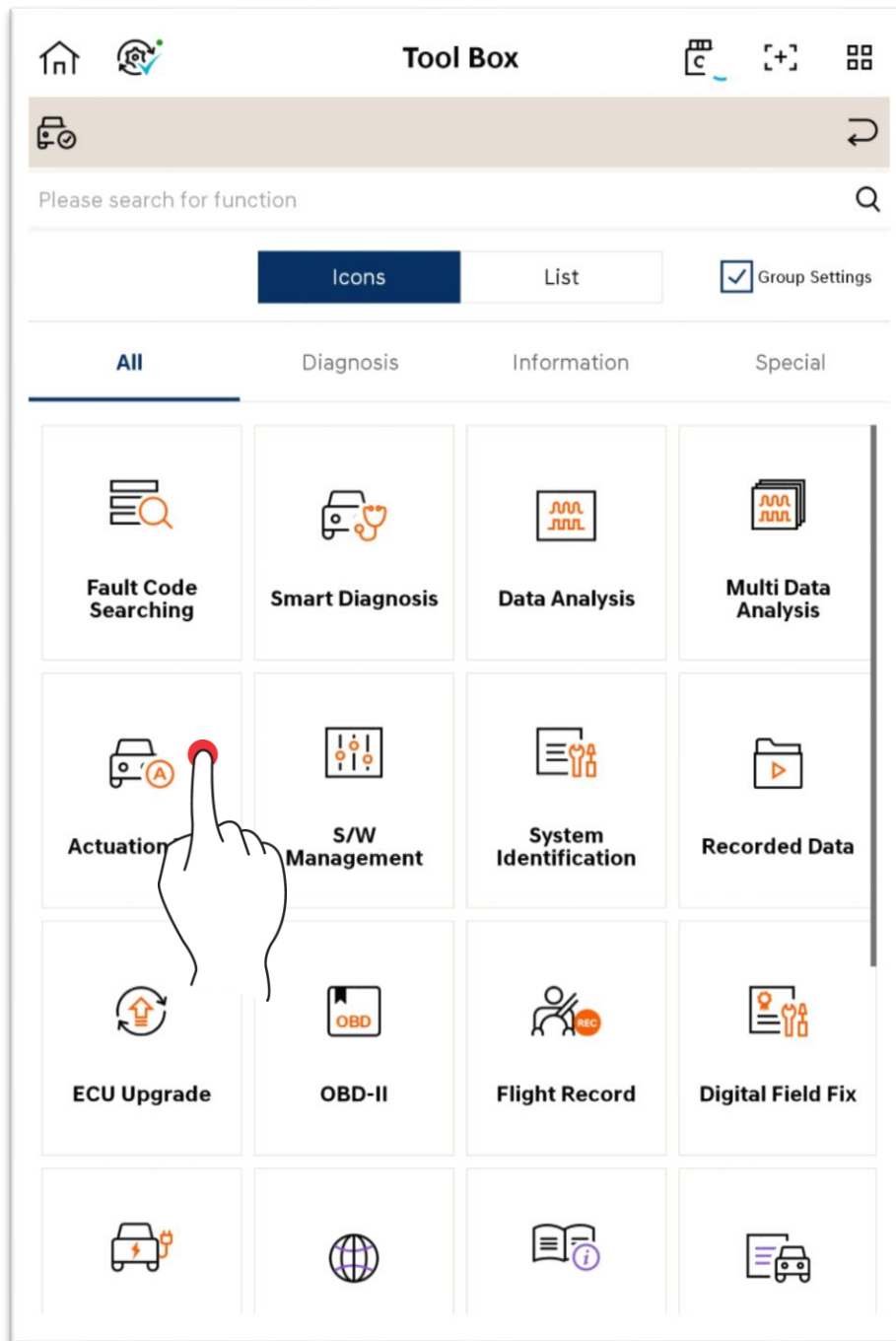

Actuation Test

It displays Actuation Test Item supported on the selected vehicle and operates the selected actuator manually.

The screenshot shows the 'Actuation Test' interface. At the top, there are navigation icons and the title 'Actuation Test'. Below the title, there are icons for 'Data Analysis (215)' and 'Time 00:00:07'. A table of sensors is displayed, with a red box highlighting it. Below the table are buttons for 'Stop', 'Data Capture', 'Clear Data', and 'Selective Display'. Below the buttons is the title 'Actuation Test' and a vertical double-headed arrow icon. Below this is a table of test items. A red circle with the number '1' is placed over the 'Cruise Control Main Lamp(Optional)' row. Below the table is a blue 'Start' button with a red circle and the number '2' over it.

Sensor Name	Value	Unit	Link Up
Immobilizer Built-in	OFF	-	
SMART Key Built-in	OFF	-	
Fuel Level Sensor Built-in	ON	-	
Fuel Tank Press Sensor Built-in	ON	-	
Low Pressure Fuel Pump Relay(Normal Closed)	ON	-	
MAP Sensor Built-in	ON	-	
MAF Sensor Built-in	OFF	-	
Alternator PWM Built-in	ON	-	

Test Items (32)	Condition	Duration	Result
Engine Check Lamp(MIL)	IG. ON/ENG.OFF	Until Stop Button	
Cruise Control Main Lamp(Optional)	IG. ON/ENG.OFF	Until Stop Button	
Cruise Control Lamp(Optional)	IG. ON/ENG.OFF	Until Stop Button	
Over speed indicator(Optional)	IG. ON/ENG.OFF	Until Stop Button	
Oil Change Warning Lamp	IG. ON/ENG.OFF	Until Stop Button	
FPCM pressure control	ENG. RUN	Until Stop Button	

Start

Data Analysis Mode

It displays the input/output value of sensor data when the user performs Actuation Test

Text Mode

This indicates the sensor data as text format.

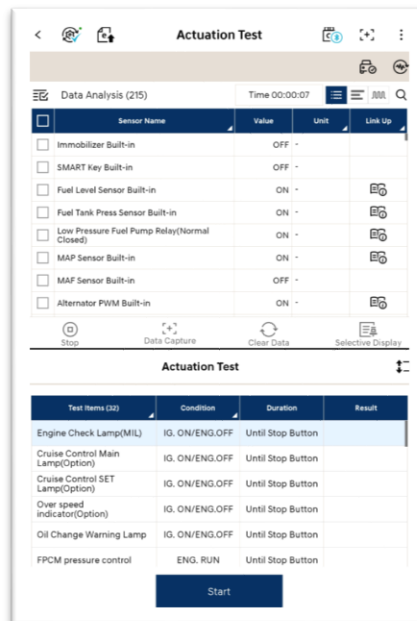

Bar Graph Mode

This indicates the sensor data as a bar graph format.

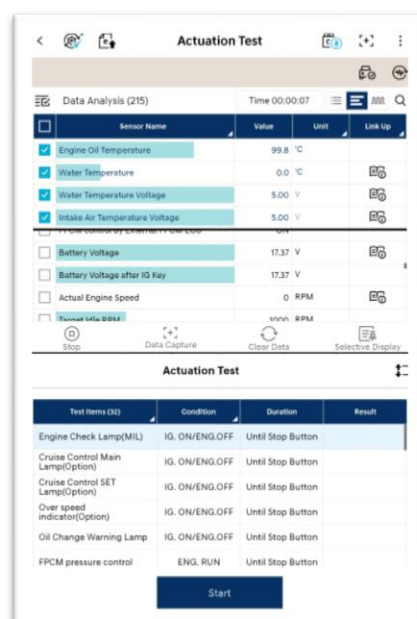

Graph Mode

This indicates a selected sensor data as a graph format.

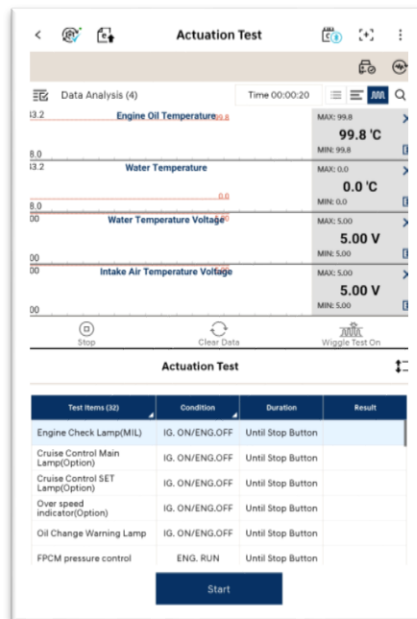

Graph Mode – Function Button

Wiggle Test On / Off

When Wiggle Test function is switched ON, the user can configure a desired data maximum/minimum value, and receive a notification if the sensor value exceeds or falls below the standard value.

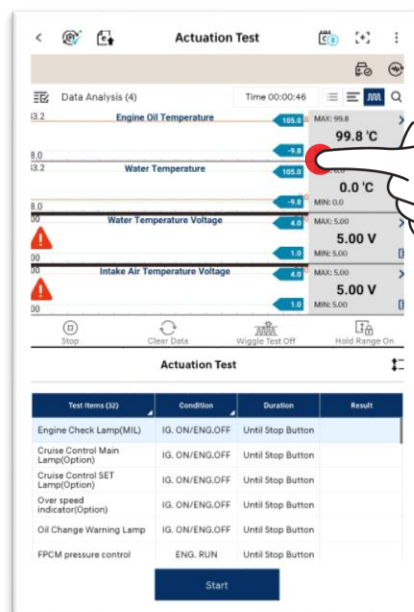

Configure the value by dragging the cursor.

 If you mute or volume is low, you may not hear an audible alarm.

Wiggle Test On – Hold Range On

If Hold Range is switched ON, it only shows the sensor values that exceed or fall below the standard value.

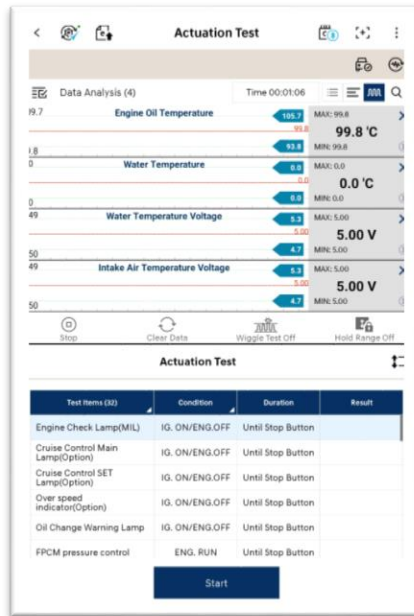

Group/User Group

Through  button on the top-left corner, the user can use Group/User Group function.

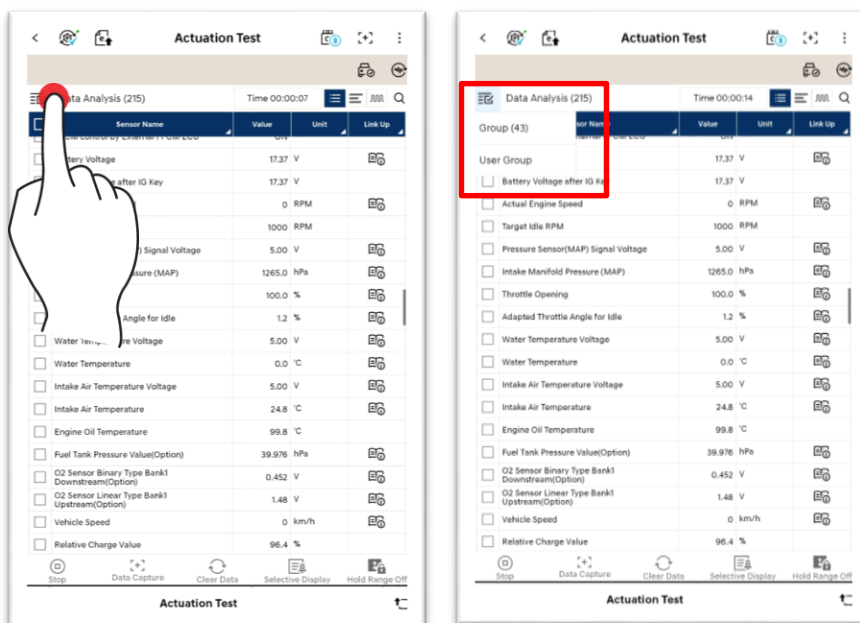

Group

It forms a group of sensor data items to express only relevant data.

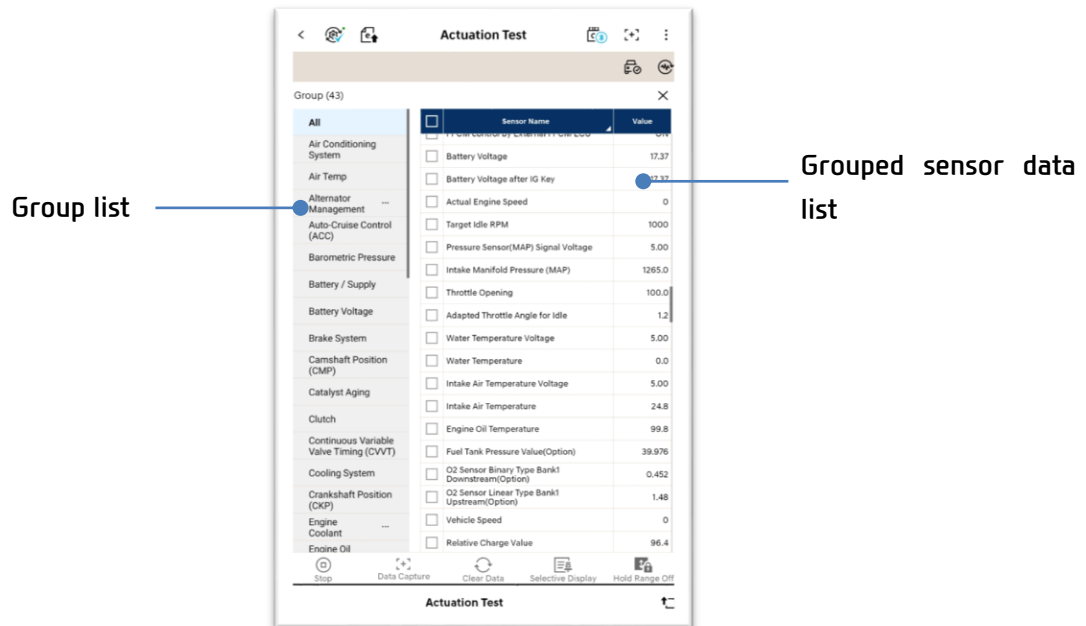

User Group

The user can form or edit a group of desired sensor data items.

1. In User Group screen, select the sensor data items to be grouped.

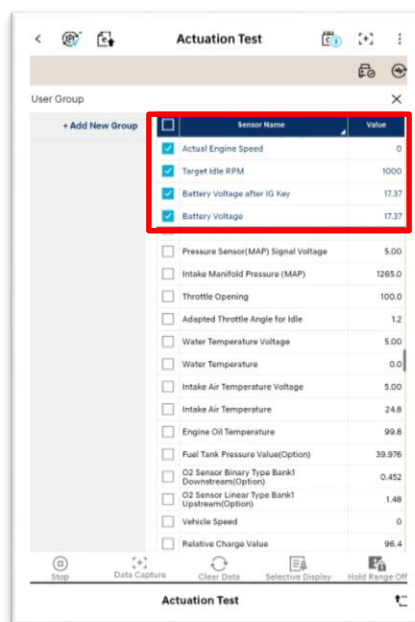

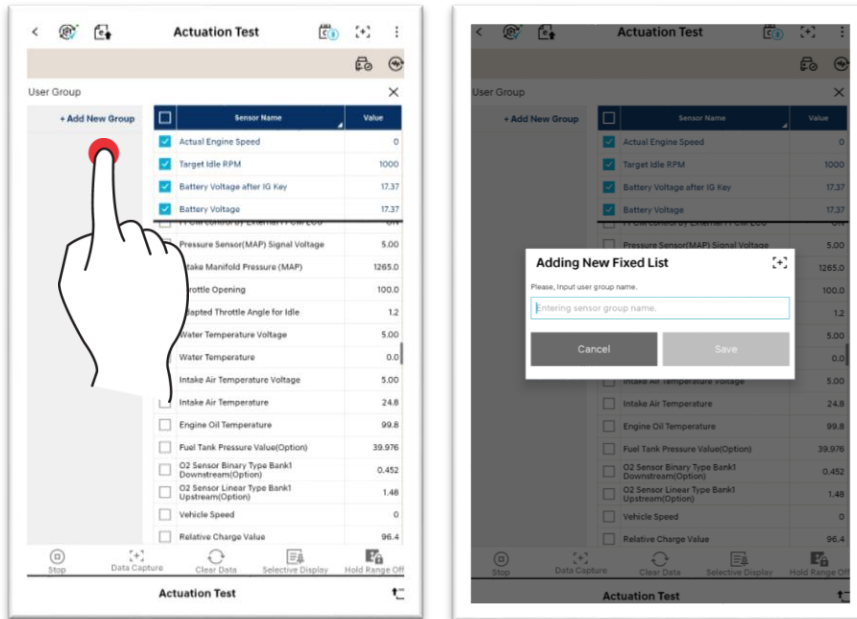

2. Once selection of items is made, form a group through 'Add a New Group'.

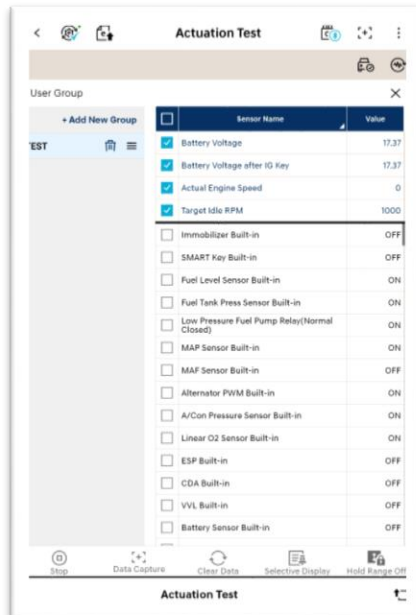

3. The group formation is completed.



		You can delete the formed group.
		You can change the group order.

Search

You can search the sensor data by entering a search word and touching .

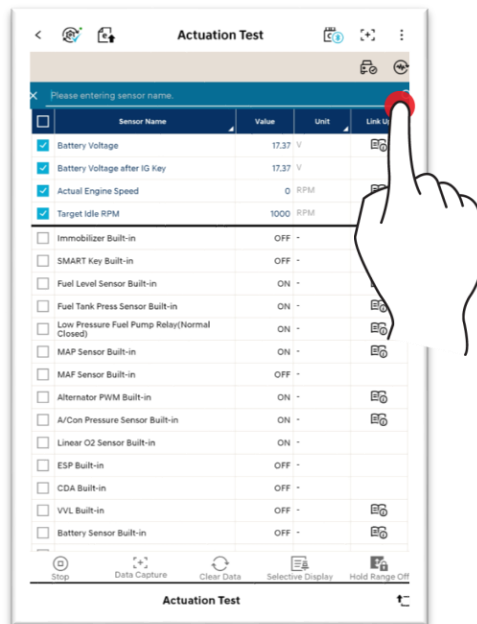



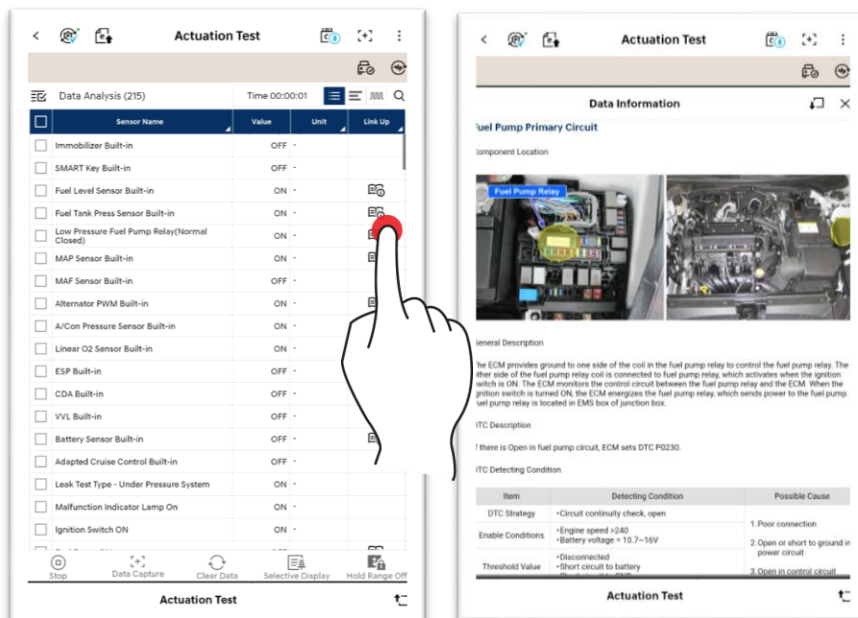

Link-up

You can check the sensor information of the selected items by touching .



Bottom Function Buttons

 Stop	This function collects sensor data values over a certain period of time, and stops the sensor data values. 'Start' and 'Stop' buttons operate in turn.
 Data Capture	This captures the sensor data screen.
 Clear Data	This initializes the collected sensor data values, and recollects them.
 Selective Display	This only shows the sensor values of the sensor data items, which were selected based on needs. The entire sensor data values are shown when Fixed Output function is turned off.
 Recorded Data	This function analyzes the saved sensor data file. This is linked to Saved Data Analysis function.

Screen Control

1. You can spread or fold the screen by dragging  upwards or downwards.

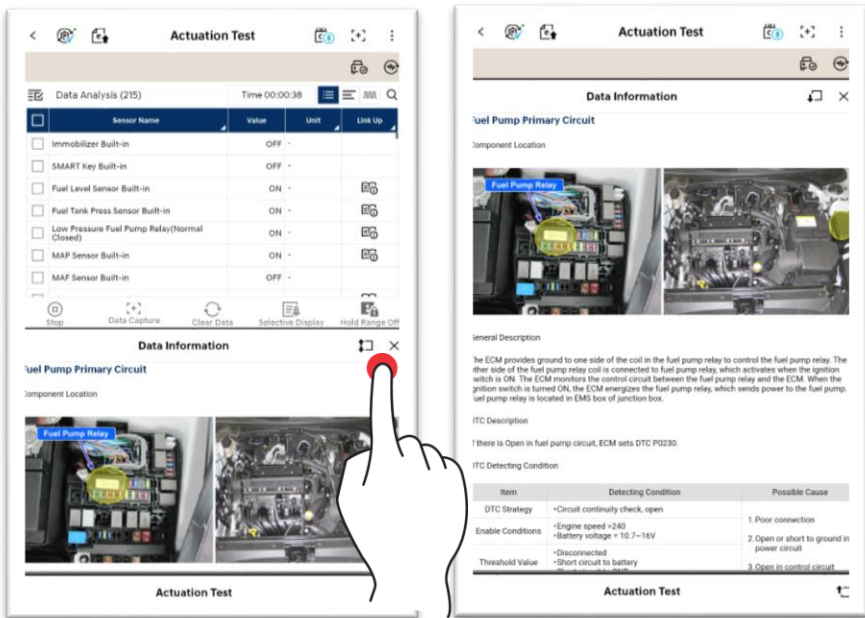

2. You can maximize/minimize the items in Graph Mode.

